

LOADING PATTERN MATING SIDE

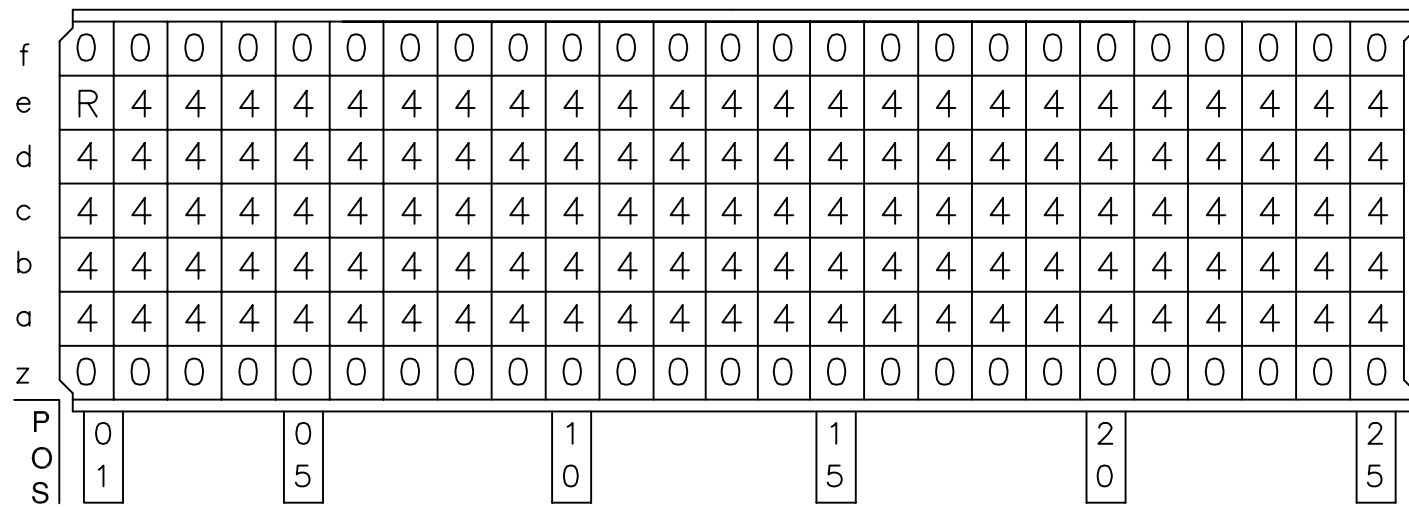

LOADED CONNECTOR ASSEMBLY (FOR EXAMPLE)

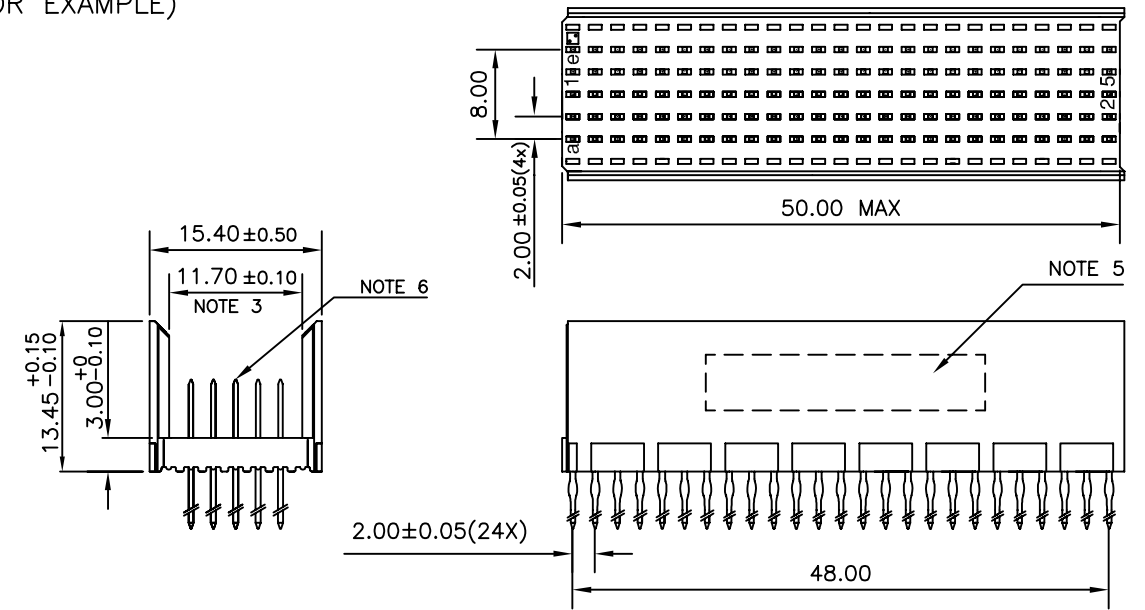

CONTACT OVERVIEW

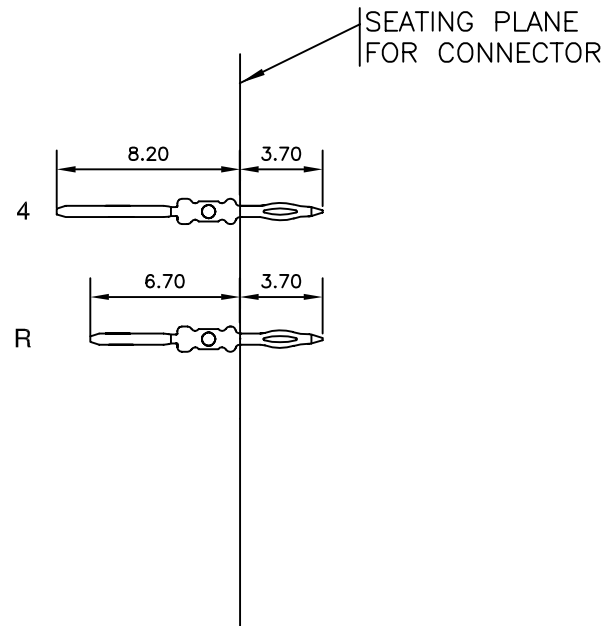

LAY-OUT P.C.B.-HOLE

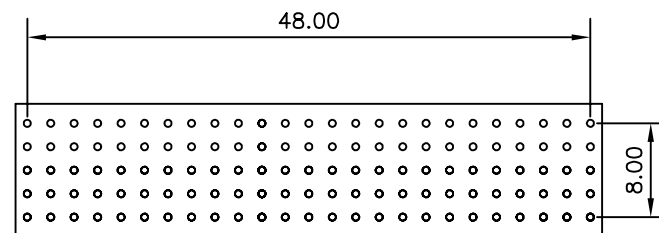

HM2P08PDR1G0 <sup>LEAD FREE INDICATOR : LF = LEAD FREE (DIGIT 15 & 16)</sup>

<sup>PLATING CODE (DIGIT 13 AND 14) (REF DRW NO. BS,C , 201844 , 003)</sup>

NOTES

1. THIS PRODUCT IS CSA APPROVED.
2. THIS PRODUCT IS UL RECOGNIZED.
3. MEASURED AT THE BOTTOM.
4. MATERIAL CONTACT: PHOSPHORBRONZE  
HOUSING: CREAM WHITE GLASS FILLED POLYESTER UL-94V0
5. CONNECTOR PRINTED WITH P/N AND DATE CODE.
6. FOR ACTUAL CONTACT LOADINGS, SEE LOADING PATTERN MATING SIDE.
7. SHAPE OF CONNECTOR HOUSING CAN ALTER DEPENDING ON PRODUCTION LOCATION
8. THE PRODUCT (LF) MEETS EUROPEAN UNION DIRECTIVES AND OTHER COUNTRY REGULATIONS AS DESCRIBED IN GS-22-008
9. FOR RECOMMENDED PTH DIMENSIONS REFER DRAWING : BS, A , 201572 , 001

CATALOG NO: HM2P08PDR1G0----

mat'l. code SEE NOTE 4				surface ISO 1302 ✓	tolerance ISO 406 ISO 1101	projection MM	product family MILLIPACS		
ltr	ecn no	dr	date	tolerances unless otherwise specified		MM	title MPACS 5+2R STR HDR PF CONN TYPE B		
A	103-0072	MINI	2003/12/13	angles	linear				
B	105-0187	MINI	2005/10/08	0°±1°					
C	106-0090	MINI	2006/06/26			scale	dwg no sheet 1 of 1 size A3		
				dr	MINI K VANDANATH	2003/12/13			
				enr	BIJU K PAUL	2003/12/13			
				chr	BIJU K PAUL	2006/06/26			
				appd	BIJU K PAUL	2006/06/26			
sheet index		revision	c	type Product Customer Drawing					